

Pole Flood ULTRA

PROJECT: _____

TYPE: _____

SOURCE: _____

NOTES: _____

SPECIFICATIONS



LED Chip	Cree CXA 2540 field replaceable LED board
Luminaire Output	5000 Lumens @ 1400 (52watts), Delivered from Luminaire with unobstructed beam.
Lumens Per Watt	90 Lumens minimum @ 52 watts, Delivered from Luminaire with unobstructed beam
CRI (3000K)	80 Standard, 90+ Optional
Colour Temperatures	2700K, 3000K, 4000K
Beam Angles	13, 22, 33, 51
Ingress Protection	IP66
Warranty	Electronics = 5 years Body Aluminium = 5 years
Standards	BS/EN 60598.2.2 cUL 1598 CE

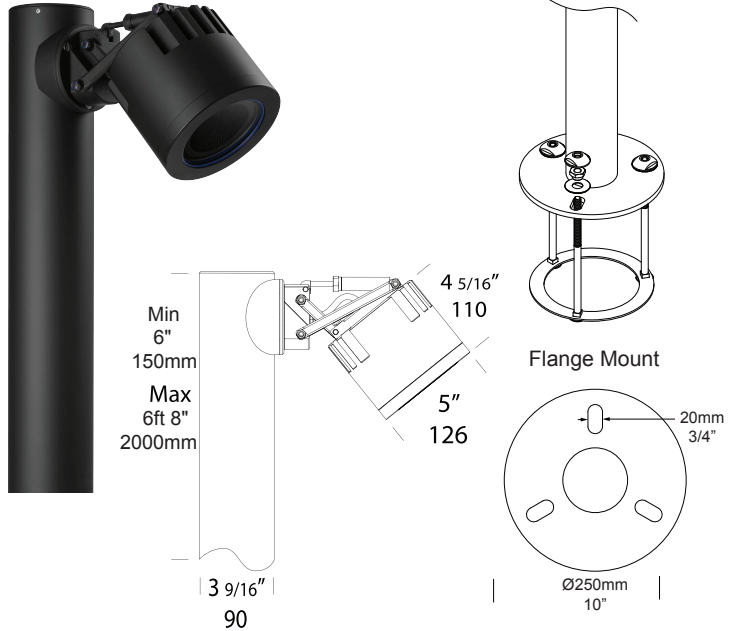

PRODUCT CONFIGURATION

Please fill in appropriate codes into boxes provided

Cat. No. PFL/U

Luminaire	Power	Material/ Finish	Beam	Colour	Accessories
<input type="text" value="PFL/U"/>	<input type="text"/>	<input type="text"/>	<input type="text"/>	<input type="text"/>	<input type="text"/>
<input type="text" value="PFLFM/U"/> <small>Pole Flood flange mount</small>		<ul style="list-style-type: none"> EBK BLACK EBZ BRONZE EOGR OLIVE GREEN ALUMINIUM EWH WHITE EWB WHITE BIRCH EDG DARK GREY ESTAR SILVER STAR ECT CORTEN 	<ul style="list-style-type: none"> 22 22° 33 33° 51 51° 13 13° Requires Lens Ring extension 	<ul style="list-style-type: none"> 2 2700K 3 3000K 4 4000K 39 3000K, 90+ CRI 	<ul style="list-style-type: none"> HCL/U HEX CELL LOUVER SNT/U SNOOT GG/U GLARE GUARD GS/U GLARE SHEILD LF FROSTED LENS MC MOUNTING CAGE CJK CABLE JOINT KIT
SR SERIES REMOTE	R RETRO, 120-277vac INPUT				

SERIES REMOTE:
Constant current driver (included)
Fixture require 37vdc @ 1400mA maximum

RETRO 110-277vac DRIVER:
Constant current driver (included)
Input: 120,240,277 volts
Output: 60 watts total
37vdc @ 1400mA
0-10 volt dimming

ADDITIONAL COMMENTS:

[Hunza Power Supply selection Chart](#)
[Hunza Voltage drop Chart](#)

LUMINAIRE CONSTRUCTION

CNC machined from one of the following metals:

Body - solid high corrosion resistant 127mm (5") aluminium rod.
 Base - high corrosion resistant 127mm (5") x 3.18mm (1/8") aluminium tube.
 Finished with chromate substrate, Epoxy layer and a UV resistant polyester powder coat colour.
 Fixings and Mechanism - made from 316 Stainless Steel

Colours:

Black, Bronze, Silver Star, White, Birch, Olive Green, Dark Grey, Corten.

Step Lens:

12mm (1/2") Extra clear, low iron, shatter resistant glass.
 Lifetime warranty

Gaskets:

Silicone, iron impregnated 220°C (428°F)

Cable:

Water resistant rubber

Mounting:

Pole is set directly into concrete.
 For flange mounting please refer to the hunza website for mounting instructions.

Luminaire Weight:

5kg (11lbs)- Head only

ACCESSORIES

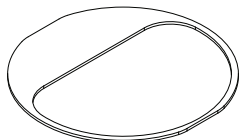

Glare Shield

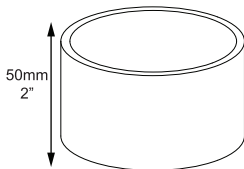

Snoot

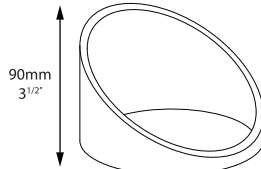

Glare Guard

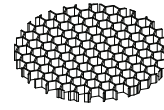

Hex Cell Louvre

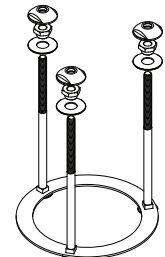

Mounting cage

BEAM ANGLES

High efficiency Reflectors. Feild replaceable

IES files available for download: www.hunzalighting.com/download.php

Lamp=4 999 lm
 Max=42 169.6 cd
 Power=61 W

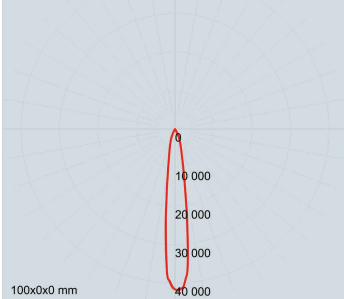

13° FWHM REFLECTOR

Lamp=5 336 lm
 Max=20 451.9 cd
 Power=61 W

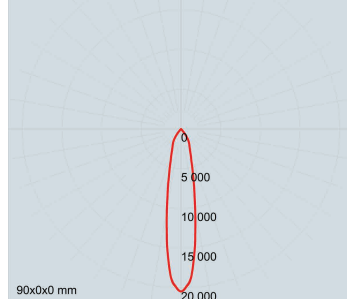

22° FWHM REFLECTOR

Lamp=5 411 lm
 Max=8 582.4 cd
 Power=61 W

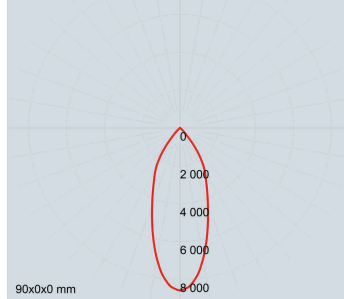

33° FWHM REFLECTOR

Lamp=5 503 lm
 Max=7 010.6 cd
 Power=61 W

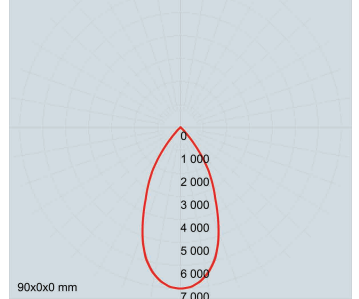

51° FWHM REFLECTOR

WIRING GUIDE

available for download: www.hunzalighting.com/download.php

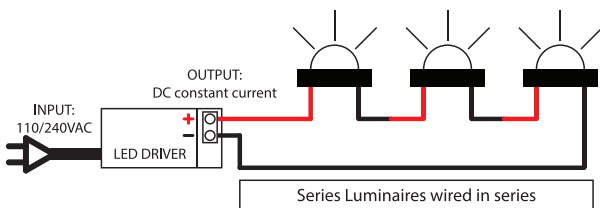

Series Luminaires wired in series

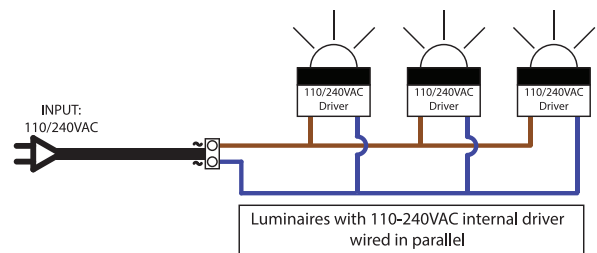

Luminaires with 110-240VAC internal driver wired in parallel

Diagrams are a guide only, wire colours and polarity may change depending on fixture and country